

Guilford County, NC - Property Report		Convert to PDF	1/14/2019
Parcel ID	Property Address	Legal Description	
1806	232 N Edgeworth St	NORTH EDGEWORTH STREET	



Mobile
Maps



Owner Information		
Owner Name	Mailing Address	City, State Zip
GUILFORD COUNTY	PO BOX 3427	GREENSBORO, NC 27402

Parcel Information			
PIN	Zoning	Use	Tax District
7864479128-000	GO-H-General Office, High Intensity	COMM	0
Parcel Size	Appraisal Nbrhood	Plat/Condo Bk & Pg	
0.71	7864C15	N/A	

Recent Sales				
Book & Page	Sale Date	Sale Price	Qualified?	Improved?
00437700472	1/15/1996	\$1,829,000	Yes	Yes

Appraisal Values			
Land	Buildings	Extra Features	Total Value
\$785,900	\$1,933,800	\$73,600	\$2,793,300

Extra Feature Summary				
Feature Description	Size/Count	Measure	Year	Value
PAVING ASP	8200	UNITS	1989	\$6,100
ELEVATOR PASSENGER/FLOOR STOPS	6	UNITS	1968	\$59,400
PAVING CON	7000	UNITS	1995	\$8,100

Disclaimer: Map and parcel data are believed to be accurate, but accuracy is not guaranteed. This is not a legal document and should not be substituted for a title search, appraisal, survey, or for zoning verification.

Appraisal Detail (Building 1 of 1)					
Bldg#	Description	Bldg Use	Yr Built	Eff Yr Blt	Units
1	17-OFFICE	04-OFF CONST	1963	1985	

Improvement Details					
Style	Foundation	Exterior Wall	Air Cond. Type	Comm. Roof Struct.	Heating Type
04-OFF CONST		FACE BRK	PACKAGE ROOF TOP		FORCED AIR-DUCTED
Heated SqFt	Bedrooms	Bathrooms	Fireplace	Building Grade	Bldg Value
			No	B+25	\$1,933,800

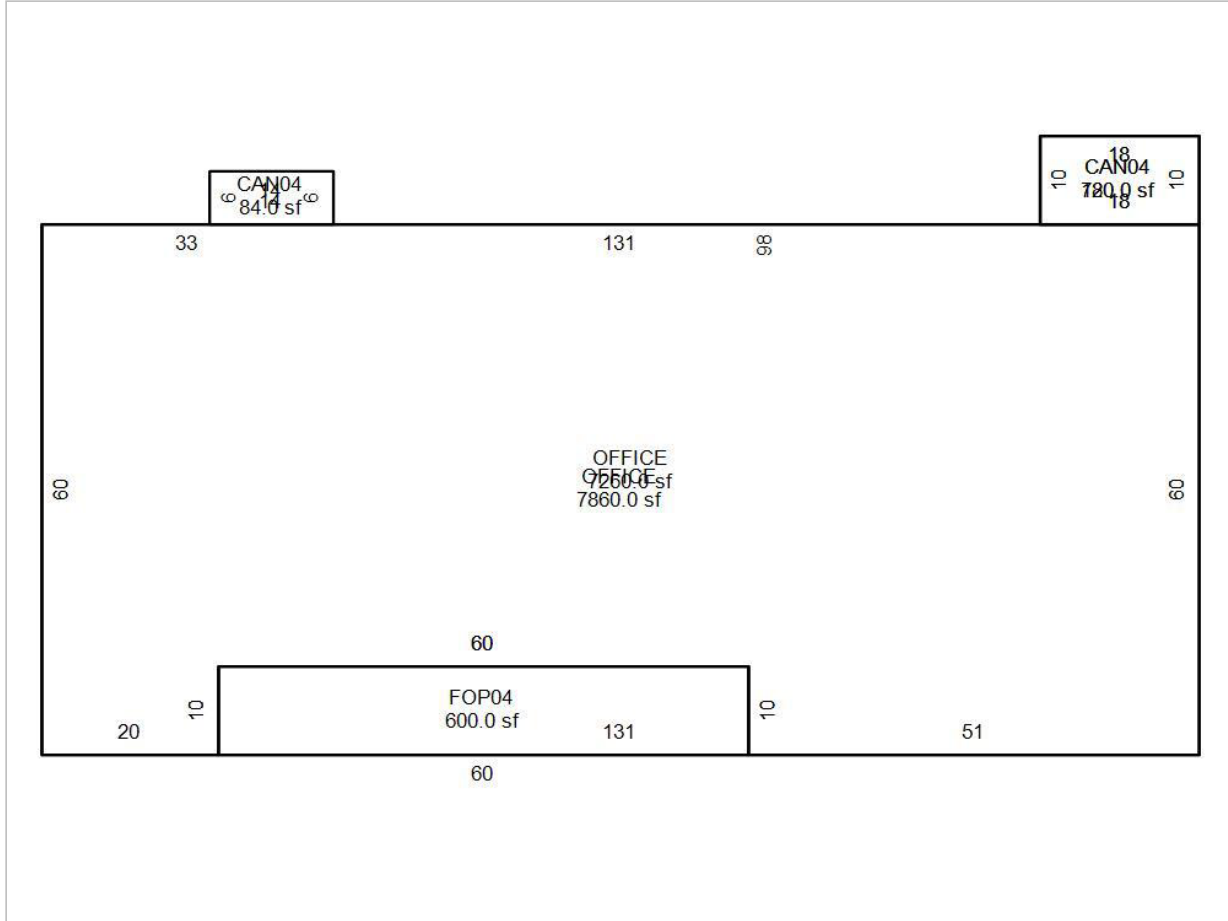

Building Area Totals		
Code	Description	Sq Feet
CAN0	Canopy	984
FOP0	Porch, Open Fin	600

Disclaimer: Map and parcel data are believed to be accurate, but accuracy is not guaranteed. This is not a legal document and should not be substituted for a title search, appraisal, survey, or for zoning verification.